

**INSIDE  
EVERY ISSUE**

**INSPIRED**  
LAYOUTS, PROJECTS  
& TRACKPLANS

**INFORMED**  
BUY THE RIGHT KIT  
FOR YOUR LAYOUT

**CREATIVE**  
BUILD YOUR OWN  
MINIATURE WORLD

**EXCLUSIVE**  
MODEL RAIL PREVIEW

[www.model-rail.co.uk](http://www.model-rail.co.uk)

# MODEL RAIL

INSPIRATION AND IDEAS FOR PEOPLE WHO LOVE MODEL RAILWAYS

## Twilight of Steam

**FREE 16-page sampler**

1960s SR shed atmosphere at Hectorage Road

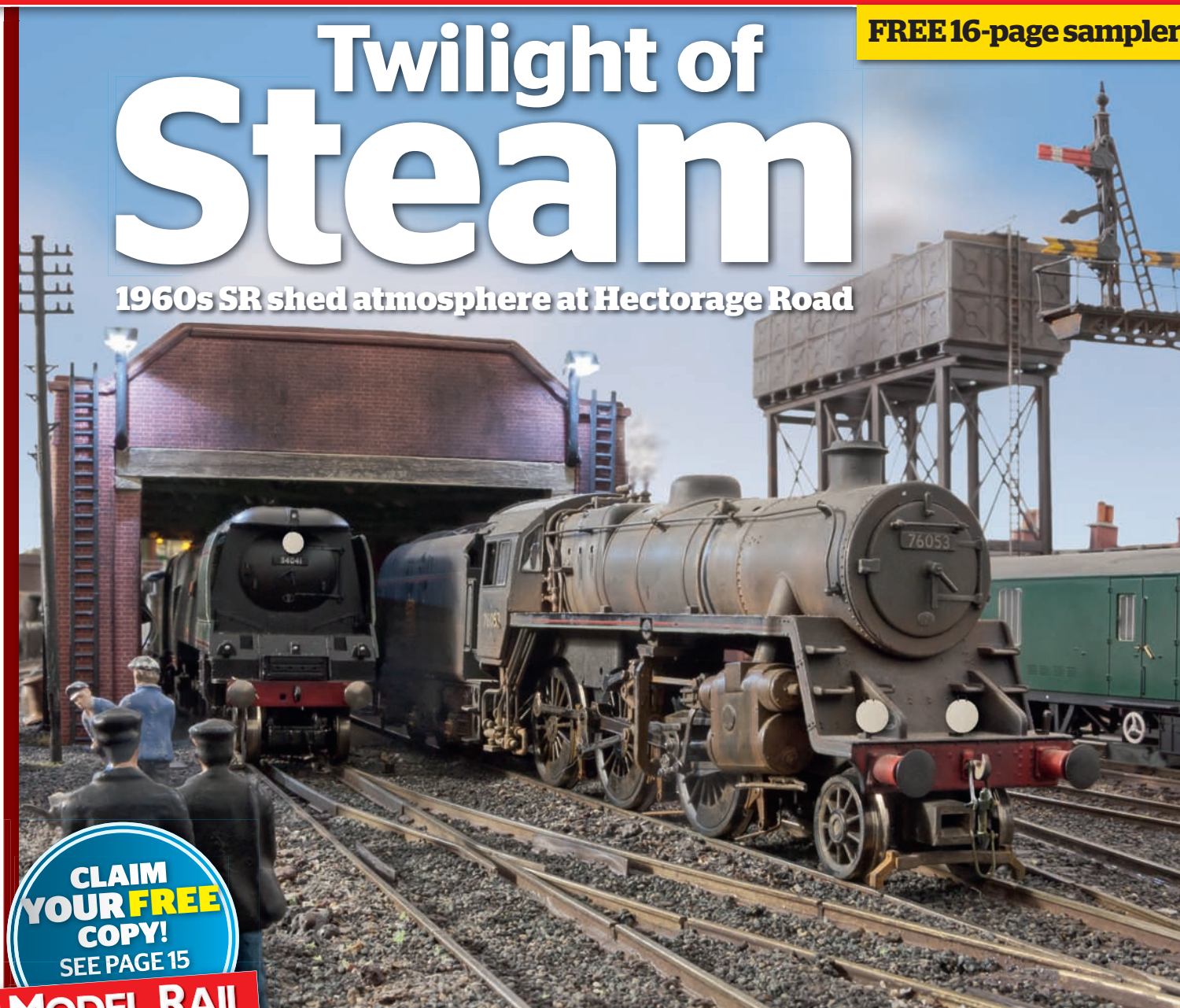

**CLAIM  
YOUR FREE  
COPY!**  
SEE PAGE 15

**MODEL RAIL**



### Layouts

Britain's most inspirational  
layouts for every scale & era



### Reviews

Independent expert reviews to  
help you buy with confidence



### Workbench

From trainset basics to finescale  
modelling, we show you how

**CLICK TO**  
**WIN  
WIN  
WIN**  
**A HORNBY**  
Diamond Jubilee Royal  
Train Pack worth  
over £200





**EXCLUSIVE**  
MODEL RAIL PREVIEW

RESERVE  
YOURS NOW!

# EXCLUSIVE TO MODEL RAIL

## USA TANKS

Our second exclusive 'OO' gauge locomotive project is the popular USA-built dock tank design adopted by the Southern Railway in 1943. Four versions will be available initially, with a number of authentic detail variations. They're selling fast so reserve yours now to avoid disappointment!

\* Liveries may vary from those illustrated

### PROVISIONAL SPECIFICATION

- Five-pole 'Supercreep' motor
- Sprung buffers
- Wire handrails
- NEM coupler pockets
- RP25 profile wheels
- DCC Ready
- Cab/bunker options
- Smokebox door options
- Extra fire irons and circular duty boards
- Etched metal front steps
- 50:1 gearing for optimum low-speed performance

**DUE  
2013**

STEAM RAILWAY COLLECTION



USATC grey No. 4326



Southern Railway black No. 68 with 'Sunshine' lettering

RAIL ARCHIVE STEPHENSON

CRL COLES/RAS



BR early-emblem black No. 30069



BR late-crest lined green No. 30064

GEOFF RIXON

ONLY  
**£104.95**  
incl. P&P  
10% DISCOUNT FOR  
MR SUBSCRIBERS  
**£94.45**

CLICK TO GET YOUR  
**ADVANCE  
TICKETS  
NOW**



CLICK TO GET YOUR  
**ADVANCE  
TICKETS  
NOW**

**TELEPHONE 01209 613984**  
or ORDER NOW at [www.modelrailoffers.co.uk](http://www.modelrailoffers.co.uk)

**IN STOCK NOW  
SENTINELS**

STILL ONLY  
**£75.00**  
incl. P&P  
10% DISCOUNT FOR  
MR SUBSCRIBERS  
**£67.50**

**OO  
GAUGE**



MR-006: LMS black  
No. 7161



MR-007: BR early crest  
black 'Y1' No. 68150



MR-008: BR early crest  
'Y1' Departmental No. 54



MR-009: Industrial lined  
black Isebrook  
Limited to 300 pieces!



MR-005: Great Southern  
Railways (Ireland) No.  
281

No money is taken until stocks of the USA Tanks arrive. Regrettably we no longer accept cheques as payment for MR models. Send orders to:  
MODEL RAIL OFFERS, 100 TRELOWARREN STREET, CAMBORNE TR14 8AN

*In every issue we tackle a range of key modelling skills, techniques and projects*



# WELCOME...

**G**reat model railways are more than a creative pastime, they're a link to childhood memories and a lost world of steam engines, long summer holidays and bunking around sheds until you get caught by the foreman. Whatever your favoured subject, the desire to re-create a little piece of 'paradise' at home is the vital spark in any project.

When you're building a model railway, sound advice can help you to overcome obstacles and create the layout you've always wanted. There's no shortage of advice out there, but how do you know if it's reliable or not? Fortunately, we're here to help.

This exclusive sampler is designed to give you a flavour of the exciting and inspirational articles you will find in every issue of the new-look Model Rail. Whether you're a novice, an 'improver' or an experienced railway modeller, you'll find our unique 'Workbench' section packed with ideas, techniques and projects that will help you to get the most from your hobby.

As well as practical step-by-step advice, we feature Britain's best home layouts - the ones you'll never see at shows - unbiased, in-depth reviews of the latest models, prototype information and much more. If you haven't seen MR for a few years, or are new to the hobby, why not give us a try?

*Ben*

Ben Jones Editor



## CONTENTS



### > INSPIRATIONAL LAYOUTS



### > MODEL OF THE MONTH



### > WORKBENCH PROJECTS

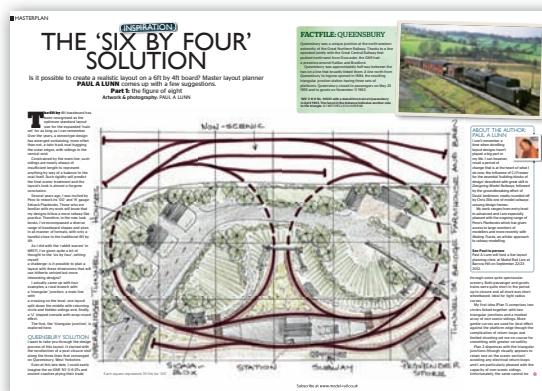

### > EXPERT LAYOUT PLANNING TIPS



CLAIM YOUR  
**FREE**  
**ISSUE**  
SEE PAGE 15  
**MODEL RAIL**



**EXCLUSIVE**  
MODEL RAIL PREVIEW

INSPIRE

# BRITAIN'S BEST HOME LAYOUTS



When you're building a model railway, there's nothing better than learning from fellow modellers. Every issue of *Model Rail* contains high quality layouts built by people of all skill levels.



CLICK HERE TO  
**SUBSCRIBE**  
NOW TO  
**MODEL RAIL**

00  
GAUGE



From steam era country branch lines...

00  
GAUGE



...to modern railways in an urban setting...

*In every issue we tackle a range of key modelling skills, techniques and projects*





ANY  
GAUGE

**EXCLUSIVE**  
MODEL RAIL PREVIEW

CLICK TO  
**WIN  
WIN  
WIN**  
**A HORNBY**  
**Diamond Jubilee Royal  
Train Pack worth  
over £200**

**N**  
GAUGE

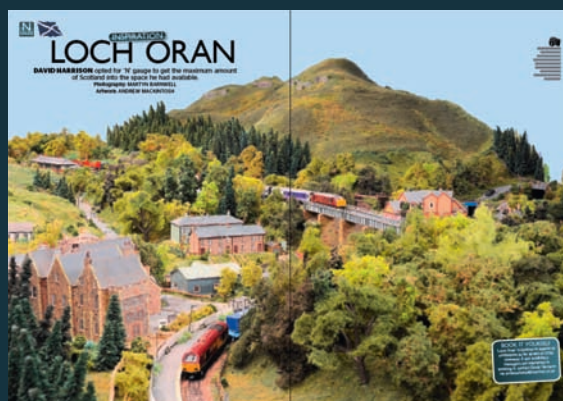

...N gauge trains in spectacular scenery...

**O**  
GAUGE



...and layouts built by famous modellers;  
*Model Rail* has all the inspiration you need!



Subscribe at [www.model-rail.co.uk](http://www.model-rail.co.uk) for monthly tips and advice





**4mm**  
SCALE

**MODEL**

Corgi Trackside  
DG225000  
Ruston-Bucyrus face  
shovel  
• Price: £19.99

**AVAILABILITY**  
Corgi stockists

**DIFFICULTY**



**ESTIMATED  
TIME**  
4 hours

**TOOLS  
NEEDED**

- Needle files
- Stiff paintbrush
- Carr's weathering powders
- Matt enamel paints
- Humbrol Metal Cote 27004
- Halfords matt black, grey and red primers

# HOW TO... WEATHER CORGI'S EXCAVATOR



**CHRIS NEVARD** explains his simple techniques for weathering a proprietary earthmover that can be applied to any die-cast vehicle.

**R**uston-Bucyrus, established in Lincoln in 1930, manufactured hundreds of excavators and earthmovers, with variations on the highly distinctive designs being exported all over the globe. If you examine archive photographs and films of quarrying and mineral extraction, you will almost certainly see Ruston-Bucyrus products in action.

Until recently, modellers seeking to reproduce one of these useful machines in miniature would have to resort to building a kit. But now, as

part of a larger range of earthmovers, Corgi Trackside has introduced this rather nifty 1:76 scale Ruston-Bucyrus RB19 face shovel that's ideal for 'OO' gauge model railways.

The model is generally a good representation of this popular design, but there are a few simple tweaks that can elevate it, capturing the spirit of the real thing and blending its somewhat toy-like finish into its immediate environment in a more convincing manner. **MR**

**KEEP AN EYE ON REAL LIFE**

It may be worth visiting a present day quarry or gravel working, to see how machinery is affected by the immediate environment. As with all weathering tasks, it helps to copy from the real thing.



Photography: CHRIS NEVARD

MICHAEL WILD/SR

CLICK TO GET YOUR  
**ADVANCE  
TICKETS  
NOW**



CLICK TO GET YOUR  
**ADVANCE  
TICKETS  
NOW**



## WHAT IS DRY-BRUSHING?

This easy-to-master technique involves applying a little of the chosen pigment to a stiff brush and then wiping most of the paint off onto a paper towel. Run the brush over the model and the tiny amount of paint will adhere to raised areas on the model.



**Before:** The Corgi model looks good fresh from the box, but the finish needs to be toned down.

**After:** The Ruston-Bucyrus RB19 looks perfectly at home as it loads an open wagon with shingle on Chris Nevard's 'Old Gravel Wharf'.

## THE RIGHT COLOURS

Muted organic colours represent rust, yet the trick is not to do too much in one go - it's easy to overdo the effect.

Select colours depending on the model's location. For example, an earthmover will quickly take on the colour of the local environment.

Humbrol's Metal Cote 27004 is great for suggesting grease. Dry-brushing gives it a lovely oily effect, and it's also useful for weathering model steam locomotives and diesel locomotive bogies.



**Expert Tip**  
Very, very lightly mist the glazing prior to reassembly with Halfords red and grey primers to remove the plastic finish, giving the effect of dust and ageing.

## HOW TO DO IT: WEATHERING A CORGI EARTHMOVER



The first job is to dismantle the model - simply remove the two screws on the underside. The string, which replicates the cable, will need to be untied, either from the jib or the plastic winch. Place all components into a box or tray.



The heavy window frame is probably the model's weakest area. However, as the body is cast from tough metal alloy, it can, with a little care, be thinned down to a more realistic and delicate level.



The trick is to make sure that all the frames match in thickness, so work slowly and with care. It's a good idea to file all the frames down, and then go over them all again. Be sure to remove any sharp burrs.



'Backwards weathering' involves applying a dark grubby finish first. The topcoat, suggesting the remnants of a factory paint finish, is then dry-brushed on top. Working this way means that the crevices and corners remain dark and dirty.



Mist on a mix of Halfords aerosol matt black and red and grey primers to produce a muddy-brown colour. This produces a fine surface texture that acts as a key for the topcoat and that looks a little like rust.



With the jib, I used a wash of dark brown diluted acrylic and then wiped most of it off to leave the factory-applied pale grey paint. There is scope for further localised weathering at a later stage to indicate wear and tear, rust and grease.



Dry-brushing creates a realistic patina, highlights detail and suggests wear and tear. It only affects the raised areas, hence the use of an initial dark coat to colour the recesses and grooves.



Assembly can be undertaken at any stage. I tend to do this just after the pre-weathering undercoat has been added. But remember there are no rules - do what suits you.

**WEATHERING POWDERS** These are useful for representing rust and age. Apply with a stiff brush in a manner similar to dry-brushing. If you want a more aggressive effect, moisten the brush a little before dipping it in to the weathering powders - this will help the powder to adhere to the model. Try not to overdo the orange/red rust powders - in real life, rust tends to be quite dark unless it's fresh.



**EXCLUSIVE**  
MODEL RAIL PREVIEW



CLAIM YOUR

**FREE**  
**ISSUE**

SEE PAGE 15

**MODEL RAIL**



**EXCLUSIVE**  
MODEL RAIL PREVIEW

celebrating

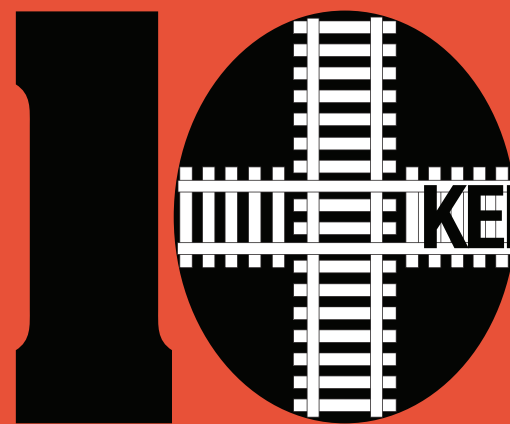

**KERNOW MODEL RAIL CENTRE**

**years**  
**2002-2012**

Visit [www.kernowmodelrailcentre.com](http://www.kernowmodelrailcentre.com) or call us on 01209 714099

UK POSTAGE & PACKING = £4 PER ORDER  
ORDERS OVER £150 = POST FREE

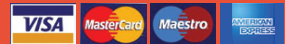

### KMRC EXCLUSIVE LIMITED EDITIONS - OO GAUGE



**D1000X** Dapol Class 22 Diesel Hydraulic No. D6315 BR Green, small yellow panel, weathered

**IN STOCK...£139.99 UK Post Free**



**D1000Y** Dapol Class 22 Diesel Hydraulic No. D6323 BR Green, small yellow panel, weathered

**IN STOCK...£139.99 UK Post Free**



**D1000Z** Dapol Class 22 Diesel Hydraulic No. D6330 BR Blue, full yellow ends, weathered

**IN STOCK...£139.99 UK Post Free**



**32-381R** Bachmann Class 37/5 Diesel Loco No. 37 521 named "English China Clays" in EWS livery, weathered

**IN STOCK.....£93.95 UK Post Free**



**31-650V** Bachmann Class 47 Diesel Loco No. 47 079 named "G J Churchward" in GW150 Green livery

**IN STOCK.....£94.93**

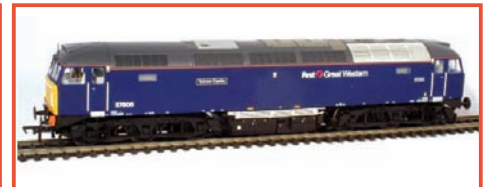

**32-752Y** Bachmann Class 57 Diesel Loco No. 57 605 named "Totnes Castle" in First Great Western Purple

**IN STOCK.....£96.99**



Dapol JIA NACCO China Clay Wagon in Imerys livery with pristine finish

**SB001A** Number 33 70 0894 020-3

**SB001B** Number 33 70 0894 000-5

**SB001C** Number 33 70 0894 001-3

**SB001D** Number 33 70 0894 002-1

**IN STOCK.....£29.99 each**



Dapol JIA NACCO China Clay Wagon in Imerys livery with weathered finish

**SB001E** Number 33 70 0894 003-9

**SB001F** Number 33 70 0894 004-7

**SB001G** Number 33 70 0894 005-4

**SB001H** Number 33 70 0894 006-2

**IN STOCK.....£34.99 each**



**32-390Z** Class 37 "Slug" Twin Pack

**IN STOCK.....£174.99 UK Post Free**

**32-390ZA** Bachmann Class 37 Diesel Loco No. 37 905 in Trainload Metals

**32-390ZB** Bachmann Class 37 Diesel Loco No. 37 906 in Original Freight

**IN STOCK.£93.99 each UK Post Free**

### OO GAUGE STEAM LOCO OF THE YEAR 2011 WINNER



**K2051** Dapol 2-4-0WT Beattie Well Tank Steam Locomotive No. 30587 in BR Black livery with early emblem.

**IN STOCK.....£91.99**



**K2053** Dapol 2-4-0WT Beattie Well Tank Steam Loco No. 30585 in BR Black livery with late crest

**IN STOCK.....£91.99**



**K2055** Dapol 2-4-0WT Beattie Well Tank Steam Loco No. 3314 Southern Black, SR Bulleid Sunshine lettering.

**IN STOCK.....£94.99**



CLICK HERE TO  
**SUBSCRIBE**  
NOW TO  
**MODEL RAIL**



**EXCLUSIVE**  
MODEL RAIL PREVIEW



**SP47** Oxford Diecast Land Rover Series 1 No. ECC 99 in English China Clays International livery  
**IN STOCK.....£4.99**

**44-087Z** Bachmann Scenecraft LSWR Stone Signal Box supplied with removable nameboard & roof  
**IN STOCK.....£27.95**

**44-061Z** Bachmann Scenecraft LSWR Brick Signal Box supplied with removable nameboard & roof  
**IN STOCK.....£27.95**

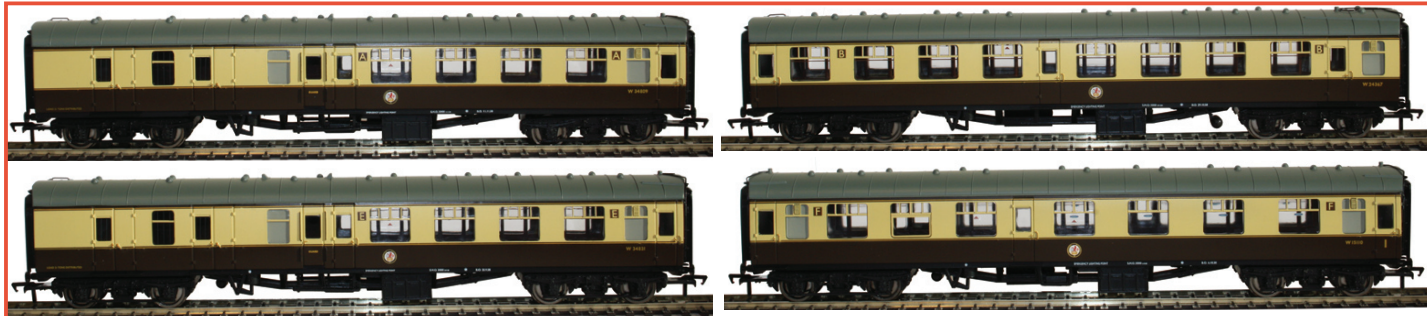

**39-000G** Bachmann Cornish Riviera Coach Pack in BR (WR) Choc & Cream with "Cornish Riviera Express" roofboards  
• BSK Brake Second Corridor Coach N° W34809 • SK Second Corridor Coach N° W24367  
• CK Corridor Composite Coach N° W15110 • BSK Brake Second Corridor Coach N° W34831  
**IN STOCK.....£114.99**



**32-425Y** Bachmann Class 24 Bo-Bo Diesel Loco No. D5072 in BR Two Tone Green, weathered  
**IN STOCK...£71.44 UK Post Free**



**32-979Z** Bachmann Class 66 Diesel No. 66 623 "Bill Bolsover" Freightliner Bardon Aggregates  
**INSTOCK...£102.12 UK Post Free**



**32-106Z** Bachmann Class 08 Diesel Shunter No. 08 691 "Terri" Freightliner, lightly weathered  
**IN STOCK...£69.95 UK Post Free**

## LATEST ARRIVALS - EXCLUSIVE LIMITED EDITIONS



**44-059Z & 44-060Z** together showing complete set-up



**44-059Z** Bachmann Scenecraft China Clay Dries Chimney & Furnace  
**IN STOCK...£43.95**

Sent post free to UK

**44-060Z** Bachmann Scenecraft China Clay Dries

**IN STOCK...£73.95**  
Sent post free to UK



**39-001T** Bachmann Network SouthEast Mk2 BR Blue & Grey Coach Pack

**NOW IN STOCK.....£59.99**

Sent post free to UK addresses only

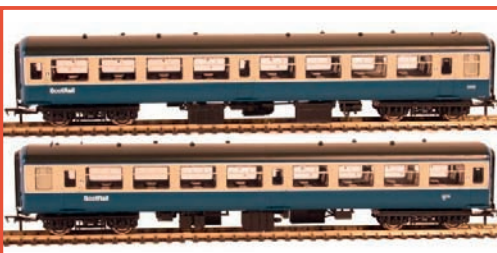

**39-001U** Bachmann ScotRail Mk2 BR Blue & Grey Coach Pack

**NOW IN STOCK.....£59.99**

Sent post free to UK addresses only

Sign up to our weekly newsletter via our website to keep up to date with delivery dates, special offers & more!

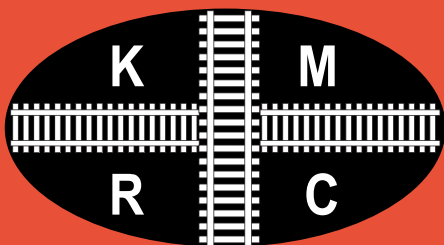

# Kernow Model Rail Centre

98A Trelowarren Street, Camborne TR14 8AN

Call our team on 01209 714099

or visit us at [www.kernowmodelrailcentre.com](http://www.kernowmodelrailcentre.com)

**CLICK TO**  
**WIN**  
**WIN**  
**WIN**  
**A HORNBY**  
**Diamond Jubilee Royal Train Pack worth over £200**





**EXCLUSIVE**  
MODEL RAIL PREVIEW

EVERY ISSUE OF MODEL RAIL BRINGS YOU HONEST, INDEPENDENT

MODELS OF THE MONTH

# MASTERPIECE BR 'PACIFICS'

Every so often a very special model comes in for review; BEN JONES takes a close look at two exquisite 7mm:1ft scale BR Standard 'Pacifics' by Masterpiece Models.

PRODUCT  
Masterpiece Models  
BR 'Clan' and  
'Britannia' 4-6-2s



PERIOD  
1951-68  
REGION  
LMR/ScR  
AVAILABILITY  
Masterpiece Models,  
Tel: 07795 562629,  
web: [www.masterpiecemodels.co.uk](http://www.masterpiecemodels.co.uk)

PRICE  
**rrp £2,950ea**

Looks  
0 1 2 3 4 5 6 7 8 9 10  
Performance  
0 1 2 3 4 5 6 7 8 9 10  
Features  
0 1 2 3 4 5 6 7 8 9 10  
Decoration  
0 1 2 3 4 5 6 7 8 9 10  
Value for money  
0 1 2 3 4 5 6 7 8 9 10  
RATING **95%**

**For**  
Exquisite build  
quality, attention to  
detail, DCC Fitted.

**Against**  
Minor decoration  
issues.

Every Masterpiece  
'Pacific' is unique;  
individually named,  
and numbered with  
period-specific  
details.



In every issue we tackle a range of key modelling skills, techniques and projects

CLICK TO GET YOUR  
**ADVANCE  
TICKETS  
NOW**



CLICK TO GET YOUR  
**ADVANCE  
TICKETS  
NOW**



REVIEWS OF ALL THE BIG NEW MODELS AND ACCESSORIES.



Attention to detail includes features such as this opening water tank filler cap on the BR1D tender.



Uniquely, the valve gear is designed to be reversible, as on full-size steam locomotives.



Fine details include hinged windshields, sliding cab windows and separate wire pipework throughout.

“MASTERPIECE HAS PRODUCED THE ULTIMATE OBJECTS OF DESIRE FOR BR STANDARD ‘PACIFIC’ FANS.”



Thanks to John Borkowski and Masterpiece Models for the loan of these models.

EXCLUSIVE  
MODEL RAIL PREVIEW



CLAIM YOUR  
**FREE  
ISSUE**

SEE PAGE 15

**MODEL RAIL**

Subscribe at [www.model-rail.co.uk](http://www.model-rail.co.uk) for monthly tips and advice



# THE 'SIX BY FOUR' SOLUTION

Is it possible to create a realistic layout on a 6ft by 4ft board? Master layout planner **PAUL A LUNN** comes up with a few suggestions.

**Part 1:** the figure of eight

Artwork & photography: PAUL A LUNN

**T**he 6ft by 4ft baseboard has been recognised as the optimum standard layout size for the expanded 'train set' for as long as I can remember. Over the years, a stereotype design has emerged containing, more often than not, a twin track oval hugging the outer edges, with sidings in the central void.

Constrained by the main line, such sidings are nearly always of insufficient length to represent anything by way of a balance to the oval itself. Such rigidity will predict the final scenic treatment and the layout's look is almost a forgone conclusion.

Several years ago, I was invited by Peco to rework its 'OO' and 'N' gauge Setrack Planbooks. Those who are familiar with my work will know that my designs follow a more railway-like practice. Therefore, in the new look books, I've encompassed a diverse range of baseboard shapes and sizes in all manner of formats, with only a handful close to the traditional 6ft by 4ft.

As I did with the 'rabbit warren' in MR171, I've given quite a bit of thought to the 'six by four', setting myself a challenge: is it possible to plan a layout with these dimensions that will use hitherto untried but more interesting designs?

I actually came up with four examples; a rural branch with a 'triangular' junction, a main line with a crossing on the level, one layout split down the middle with returning circle and hidden sidings and, finally, a 'U' shaped console with wrap round effect.

The first, the 'triangular junction', is explored here.

## QUEENSBURY SOLUTION

I want to take you through the design process of this layout. It started with the recollection of a post closure visit along the three lines that converged on Queensbury, West Yorkshire.

Even at this late date, I could easily imagine the ex-GNR 'N1' 0-6-2Ts and ancient coaches plying their trade

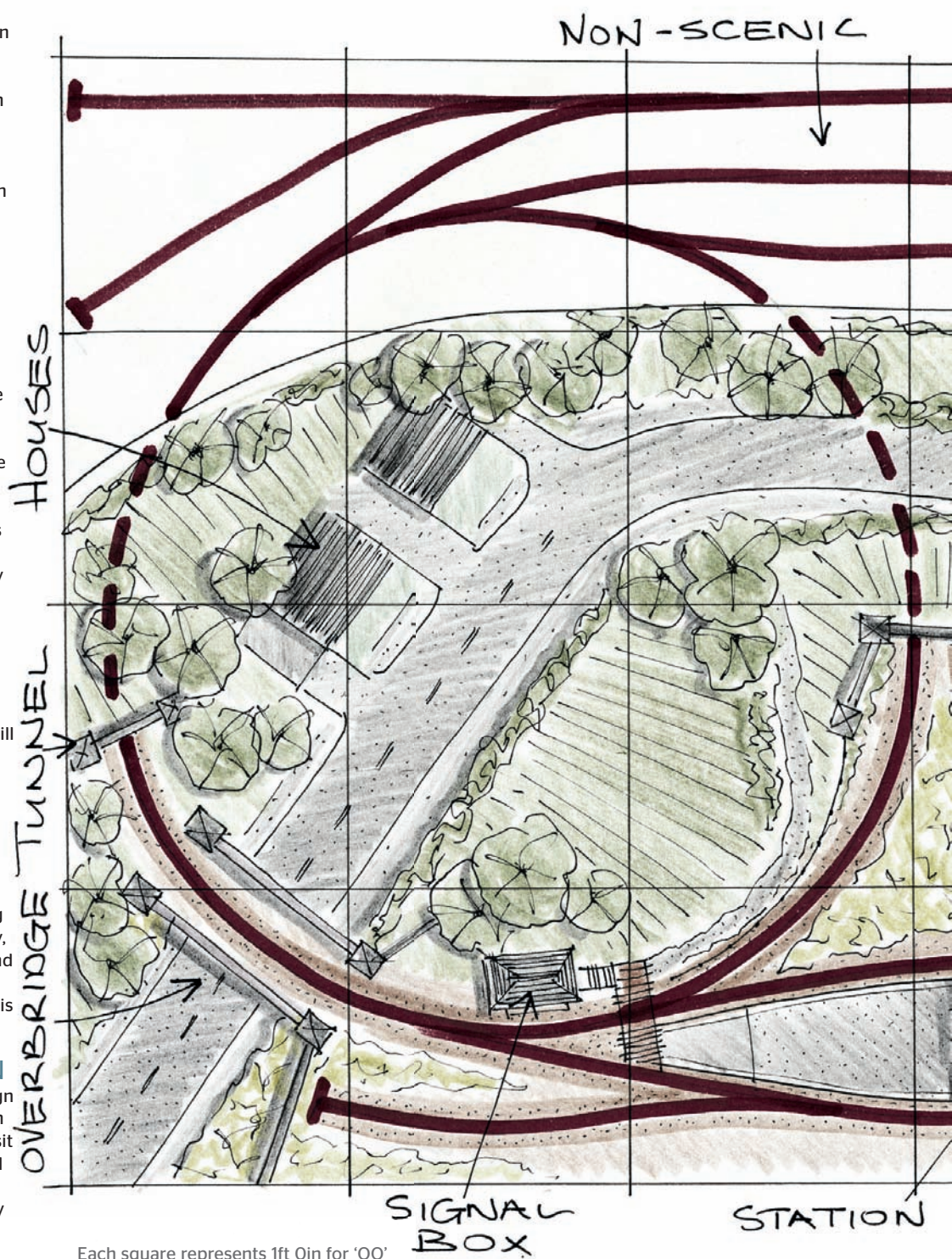

Each square represents 1ft 0in for 'OO'



CLICK HERE TO  
**SUBSCRIBE**  
NOW TO  
**MODEL RAIL**



## FACTFILE: QUEENSBURY

Queensbury was a unique junction at the north-western extremity of the Great Northern Railway. Thanks to a line operated jointly with the Great Central Railway that pushed north-west from Doncaster, the GNR had a presence around Halifax and Bradford.

Queensbury was approximately half-way between the two on a line that broadly linked them. A line north from Queensbury to Ingrow opened in 1884, the resulting triangular junction station having three sets of platforms. Queensbury closed to passengers on May 23 1955 and to goods on November 11 1963.

'WD' 2-8-0 No. 90333 with a demolition train at Queensbury in April 1963. The fence in the distance indicates another side to the triangle. DJ MITCHELL/COLOUR-RAIL

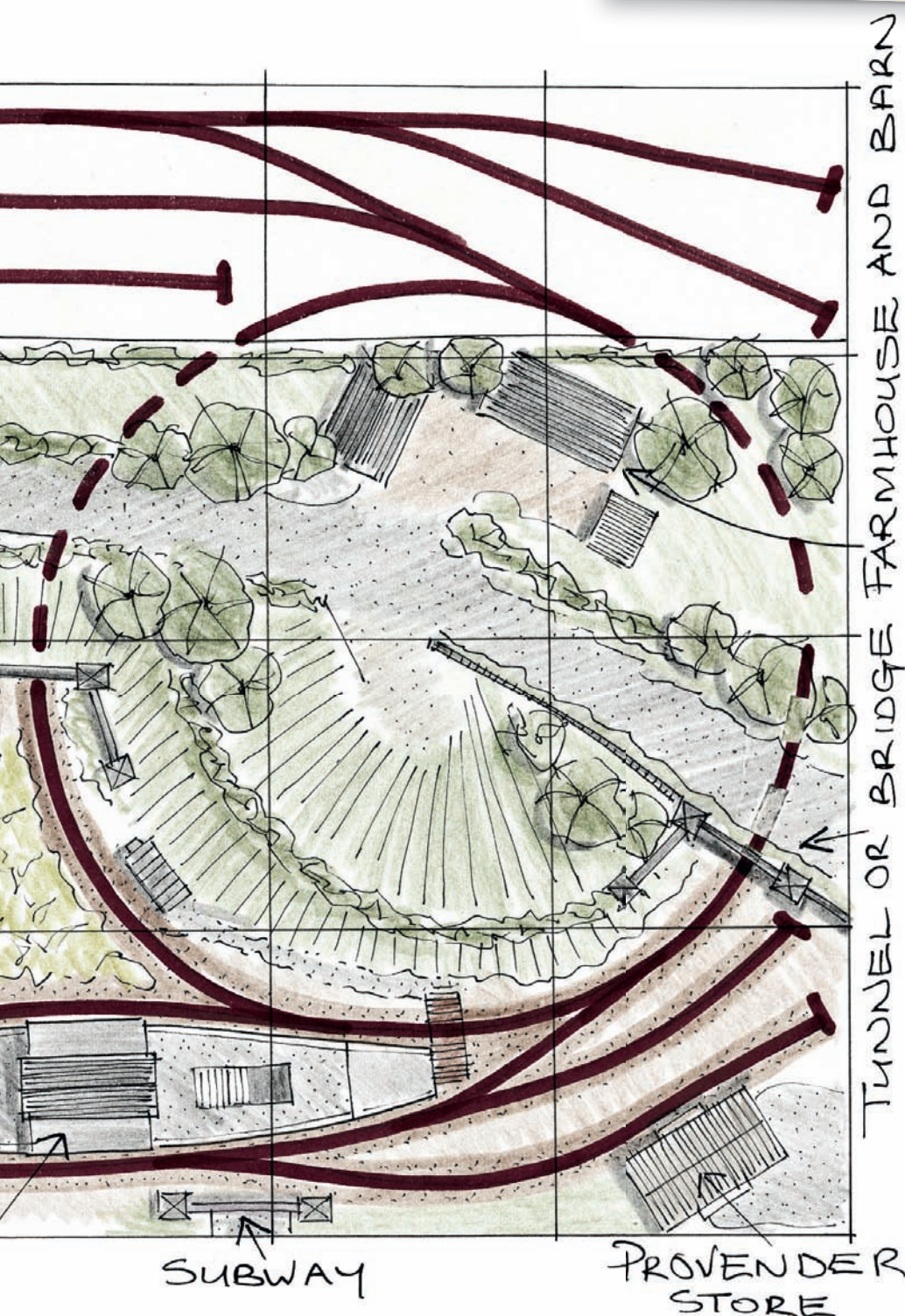

### ABOUT THE AUTHOR: PAUL A LUNN

I can't remember a time when doodling layout designs hasn't played a big part in my life. I can however, recall a period of change that is at the heart of what I do now; the influence of CJ Freezer for the essential 'building blocks of design' described with great skill in *Designing Model Railways*, followed by the groundbreaking effort of David Jenkinson, neatly rounded off by Chris Ellis one of model railways' unsung design heroes.

My work ranges from entry-level to advanced and I am especially pleased with the ongoing range of Peco's Planbooks which has given access to large numbers of modellers and more recently with *Making Tracks*, an artistic approach to railway modelling.

#### See Paul in person

Paul A Lunn will host a live layout planning clinic at Model Rail Live at Barrow Hill on September 22/23 2012.



through some quite spectacular scenery. Both passenger and goods trains were quite short in the period up to closure and all stock was short wheelbased, ideal for tight radius curves.

My first idea (Plan 1) comprises two circles linked together with two triangular junctions and a modest array of non-scenic sidings. More gentle curves are used for best effect against the platform edge though the complication of return loops and limited shunting set me on course for something with greater versatility.

Plan 2 dispenses with the triangular junctions (though visually appears to retain one on the scenic section) avoiding any electrical return loops and I am particularly pleased with the capacity of non-scenic sidings. Unfortunately, the same cannot be

**EXCLUSIVE**  
MODEL RAIL PREVIEW

**CLICK TO**  
**WIN**  
**WIN**  
**WIN**  
**A HORNBY**  
**Diamond Jubilee Royal**  
**Train Pack worth**  
**over £200**





# MODEL RAIL EXCLUSIVES

Welcome to the Model Rail Shop, the only place to buy Model Rail's exclusive 'OO' gauge limited edition models.

Order online at [www.modelrailoffers.co.uk](http://www.modelrailoffers.co.uk)  
or telephone **01209 613984**

## NEW! BACHMANN 31-650R PROVINCIAL SERVICES CLASS 47/4 DIESEL 47475

To complement our limited edition Bachmann Trans-Pennine Mk 2a coaches (see below), we've commissioned a model of the unique Provincial Services livery Class 47/4, which was a regular performer on the Liverpool-Newcastle and associated routes in the late 1980s and early 1990s. The Bachmann model features a 21-pin DCC decoder socket, directional headlights and switchable cab lights, plus all-wheel drive and pick-up. Limited to 500 pieces.

**£115.95** (MR subscribers £104.35) inc. P&P.



**DUE SUMMER 2012**

**DUE SEPTEMBER 2012**



## HORNBY R3001 RAF BATTLE OF BRITAIN MEMORIAL FLIGHT 91110

This very special exclusive model is being produced in conjunction with East Coast and the RAF Battle of Britain Memorial Flight. Featuring stunning artwork based on the unique '91', an upgraded motor and eight-pin DCC decoder socket, this model will become a sought-after collectors item. More than 50% of the 1,000 piece limited edition has already been reserved. £5 from each model will be donated to the RAF Benevolent Fund.

**£109.95!** inc. P&P (MR subscribers save 10% £98.95)

## NEW! BACHMANN 39-000N TRANS-PENNINE MK 2A COACH PACK



**NEM**

**IN STOCK NOW!**

To complement Provincial 47475, see above, we've commissioned a matching pair of Trans-Pennine Mk 2a coaches (39-000N) consisting of Tourist Second Open 5321 and First Corridor 13445, as used on

Please note that due to price increases imposed by the manufacturer, it has been necessary to increase the retail prices on forthcoming items. All existing orders at the old price will be honoured on the Network Rail Mk 1, Satlink Mogo and Trans-Pennine Mk 2 pack.

Trans-Pennine services in the late 1980s and early 1990s. Extra Trans-Pennine Mk 2a TSOs will be made available later.

**£67.50** (MR subscribers £60.75) inc. P&P.

## BACHMANN 32-110Z BR BLACK CLASS 08 D3052



Willesden-based D3052 was one of several Class 08s to run in BR black with black/yellow 'wasp' warning stripes into the early 1970s. Known to have been used as station pilot at London Euston, it is suitable for steam/diesel transition-era layouts. **SPECIAL OFFER: BUY THIS MODEL AND RECEIVE A FREE BR LAND ROVER!**

**£71.00** (MR subscribers £64) inc. P&P



**FREE LAND ROVER OFFER**

## BACHMANN 37-779Z SATLINK 'MOGO' KDW65742

Advance orders are now being taken for the next wagon in our popular 'Satlink' series - a former GWR 'Mogo' road vehicle van. KDW 65742 was part of the London Midland Region Satlink fleet based at Preston in the late 1980s and early 1990s. The 'OO' model features a prototypical yellow roof and printed details.

**£14.99** (MR subscribers £13.49) inc. P&P

**NEM**



**IN STOCK NOW!**

**CLICK TO GET YOUR  
ADVANCE  
TICKETS  
NOW**



**CLICK TO GET YOUR  
ADVANCE  
TICKETS  
NOW**

**TELEPHONE: 01209 613984** (MON-SAT: 0930-1700, SUN: 1000-1600)  
for enquiries and to place your order.



INSPIRATION AND IDEAS FOR PEOPLE WHO LOVE MODEL RAILWAYS

# CLAIM YOUR FREE COPY OF



- Inspirational layouts ■ Expert modelling advice
- Step-by-step modelling projects ■ Reviews ■ Plus much much more...

Call **0800 665492**  
to claim your free copy or text **KERNOW** to 78070.

**Terms and Conditions:** Lines are open 8:00am - 20:00pm Monday-Friday and 9:00am-17:00pm Saturday and Sunday. This offer is available for UK addresses only - one copy per household, and subject to availability, currently only available to the first 2,000 subscribers. Offer ends 31/12/2012. Calls will cost no more than 5p per minute from a BT landline. Calls from mobiles and other providers may vary. You will receive the next available issue after receipt of your order.

Subscribe at [www.model-rail.co.uk](http://www.model-rail.co.uk) for monthly tips and advice

**EXCLUSIVE**  
MODEL RAIL PREVIEW



CLAIM YOUR  
**FREE  
ISSUE**  
SEE PAGE 15  
**MODEL RAIL**



**EXCLUSIVE**  
RAIL PRO

**ADVANCE TICKETS  
ON SALE NOW**

## MODEL TO FULL SIZE TRAINS - CATCH THEM ALL IN ACTION



**CLICK HERE TO  
SUBSCRIBE  
NOW TO  
MODEL RAIL**

**LIVE** 

**SEPTEMBER 22-23 2012**

supported by  
**STEAM**  
RAILWAY

in association with



**HORNBY®**

- **MODEL RAIL LAYOUTS OF ALL SHAPES & SIZES**
- **MEET THE EXPERTS**
- **STEAM TRAIN RIDES**
- **MODELLING WORKSHOPS**

- **TRADE VILLAGE**
- **EXCLUSIVE SHOW OFFERS**
- **DIRECT RAIL SHUTTLE TO THE EVENT\***
- **VISITING STEAM ENGINES**

**Advance tickets from just £10 per adult\*\***

**BOOK YOUR TICKETS NOW call 08445 811383 or visit [www.modelraillive.co.uk](http://www.modelraillive.co.uk)**

**FIND US AT BARROW HILL ROUNDHOUSE MUSEUM, CAMPBELL DRIVE, BARROW HILL, CHESTERFIELD, DERBYSHIRE S43 2PR**

\* Return shuttle train - unreserved access on next available train to/from show. \*\*All tickets subject to booking fee