

NEW ITEMS N^o 1 2019



INSIGHTS

Current projects

PROSPECTS

2019 Highlights

FOCUS

Bridge construction,
Colour variants

TECHNOLOGY

Drive kits for models



BIG IN SMALL THINGS

KIRMES 1

H0 4

Trade, business, industry	4–6
Railway stations, railway buildings	7–9
Scenic modelling	10–11
The town, the village	12–18
Miniature figures	18
Monthly models	19



New technique in marshalling yard

Goods waggons roll over the hump with loud creaking and flying sparks towards the tracks intended for them. Smooth operation is ensured by installing the »Rail brakes« on **page 9**.



**Highlight
2019**

N 20

Railway station/The town, the village	20
Business/The town, the village	21
The town, the village/Scenic modelling	22–23

Meeting-place for sports enthusiasts

Limited PREMIUM Model 2019 is the »Gymnasium« flooded with light on **pages 16/17**. It's definitely a home victory for your installation and the spectator stand is boiling with enthusiasm!

CAR SYSTEM 24

Car System Digital	24
Car System	25

ANLAGENBAU 26

Trees, clump foliage, grass tufts	26–27
Electronics, utilities	28
Small parts	29







An altogether effective emblem



Impassable terrain along rivers, lakes or mountainous landscapes is overcome by the newest bridge for the N gauge on **page 23**, a construction with fascinating radiance.

Symbolism

Track gauge

 H0	1:87 16.5 mm	 N	1:160 9 mm
 T	1:120 12 mm	 Z	1:220 6.5 mm

Periods

 Epoch I	1880–1920	 Epoch IV	1978–1985
 Epoch II	1921–1945	 Epoch V	1986–2006
 Epoch III	1946–1977	 Epoch VI	2007–today



Highlight
2019

140418

»DAEMONIUM«

Experience the creeps in a fully new dimension, and let you frighten and scare on several levels.

Epoch V - 415 × 235 × 235 mm



140119

»Caesar's Palace« Ticket booth

Pure luxury and plenty of winners, that's what venturers are going to find in »Caesar's Palace«, stationary model of a former funfair lottery booth which was designed by the Workshop for Applied Advertising (»afaw«) to pay homage to that legendary casino resort in Las Vegas, with antique motifs and period elements.

Epoch V - 222 × 78 × 118 mm - 04/19

Trade fair dates 2019

Shall we meet there?

Experience FALLER live: it's possible in Baden, Franconia, Saxony, Westphalia and Württemberg. Anyone who wants to do it in a more international way can also meet us in France, the Netherlands, Italy, Austria or Poland. Anywhere you want, any time you want – we look forward to it!

Intermodellbau

Dortmund

April 04 – 07, 2019

www.westfalahallen.de/messen/intermodellbau

IMA and Märklin Tage

Göppingen

September 13 – 15, 2019

www.maerklin.de

Modeltrein Expo On traXS!

Utrecht, Netherlands

March 15 – 17, 2019

www.spoorwegmuseum.nl

You will find further trade fair dates for 2019 at www.faller.de

Workshops

Let's tackle it together!

Know-how on site: On our premises in Gütenbach we shall show you how thrilling and diversified scale modelling can be. Model layout, Car System or Car System Digital: in our workshops newcomers and advanced modellers will learn from experienced professionals, and will take home useful tips for their project. Just book a place now – and take part!

Layout Construction seminar

Topic: Rushing brook

08-10 March 2019

Layout Construction seminar

Topic: Bridge day

30 August-1 September 2019

Car System Digital seminar

15-16 March 2019

Car System Base seminar

20-22 September 2019

Car System Base seminar

17-19 May 2019

Car System Digital seminar

11-12 October 2019

Layout Construction seminar

14-16 June 2019

Car System Digital

vehicle conversion

14-15 October 2019

12 highlights

Monthly models

Model of the month
April

Exclusive special models and authentic re-editions in limited quantity: With its coveted Models of the month FALLER addresses twelve times a year all passionate scale modellers who are in search of the unusual. Here it's worth being fast!

Look for the marked products.

More choice

Colour variants

Colour
variant

Colours transform everything. Our kits differing by the colours demonstrate it in an impressive way. Model variants enlarge the entire collection as surprising alternatives or spectacular complements, while offering appealing good value at the same time.

Look for the marked products.

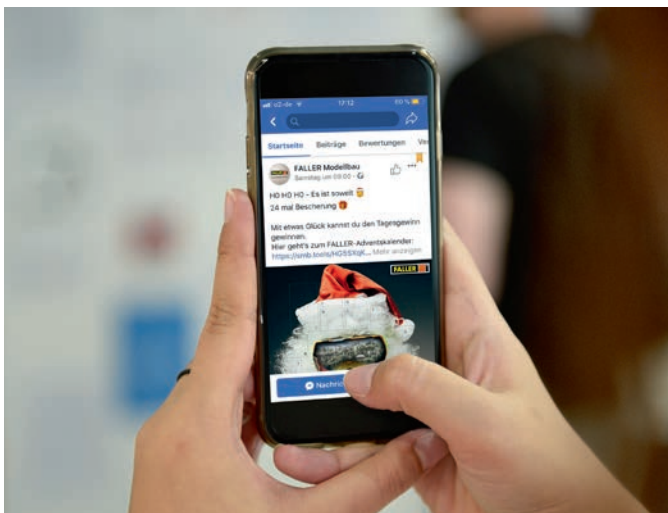

Facebook, YouTube



Videos, info, aid, and exchange of experience: whenever the online media are involved, FALLER is one of the party! No wonder: the scale modelling community is well interconnected worldwide, and grows with the passion and dedication of everyone. So just have a look around, share, place a like, and take part!



Online Newsletter



Secure benefits

No longer miss anything! All information on new items, products, trends, and dates – FALLER's Online Newsletter summarizes all this briefly and succinctly. Whoever hasn't subscribed yet, should best do it right now.

Mikro Länder



A club to the third power

Three brands, more benefits: Our club reinvents itself. In future the denomination MIKRO LÄNDER will include three strong brands (BUSCH, FALLER and PREISER) which have a lot of things to offer to their members: free catalogues, special models as well as discounts on admission cards to trade fairs, events and exhibitions. Here is the way to registration: www.mikrolaender.de

Advice and repair

We'll adjust it

Always the right contact: no matter whether you have any question regarding the product or need professional maintenance – we shall be pleased to be of assistance by e-mail or on the phone.

E-mail: kundendienst@faller.de

Phone: +49 7723 651-106

Monday: 8.00 – 16.00 hours

Tuesday to Thursday: 8.00 – 12.00 hours

Publications

Once a year is not enough

Current highlights: from now on our leaflets will appear several times a year and be complemented by topical fliers on products, themes and new items.

Additional leaflets: All details hot off the press: along with the general catalogues of FALLER and POLA G various further leaflets will appear which contain detailed information and new items from the big world of FALLER brands. Available at your retailer's shop, or to download on our website: www.faller.de



Faller Classics

REAL COLLECTIBLES – REISSUED!

109923

B-923 Town wall

Town wall with built-in square fortified tower and old-town wall part with wall-walk directly leading to a dwelling house.
First launch: 1965.

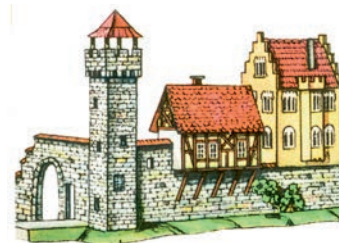

Epoch I • 249 × 184 × 142 mm • 06/19



120290

Container bridge-crane

Intermodal centre of activity. Transshipment station ensuring container traffic according to the original DUSS terminal of DSD HILGERS company on the Basle/Weil-on-the-Rhine site.

Epoch IV - 654 × 353 × 268 mm - 02/19

Month of
delivery
02/19

180290

Drive kit for container bridge-crane

Cross-platform! Container bridge-crane, Art. 120290, is controlled without software installation, that is exclusively browser-based from any WLAN-capable desktop computer, notebook, smartphone or tablet (any such device not supplied). Functions: motion chassis forward/backward, motion travelling crab to the left/to the right, motion spreader up/down. Mobile elements can be stopped in any position. Products supplied: 4 motors, 2 motor regulating units, gears, toothed wheels, shafts, ball bearings, screws, stranded wires. Required Li-ion rechargeable batteries AA (Mignon) 3.7 V available separately.

The decision to realize the Container bridge-crane model with motorization must be made prior to the assembling procedure. Retrofitting the model is absolutely not possible.

Highlight
2019





130134

4 Building site containers, blue

Epoch V - 70 × 28 × 33 mm (4 x) - 02/19

Direct to the huge selection



FALLER.DE
NEW ITEMS



130135

4 Building site containers, orange

Epoch V - 70 × 28 × 33 mm (4 x) -
02/19



130136

**4 Building site containers,
black-yellow / grey-black**

Epoch V - 70 × 28 × 33 mm (2 x),
35 × 28 × 33 mm (2 x) - 02/19



6

130890

»Goldbeck« Industry hall

All parts forming the basic hall such as steel structure and supports, wall and roof elements, strips of windows and rooflights, rolling shutter doors which can be fixed in the open or closed position, and the travelling trolley within the hall can be arranged at will. Through traffic possible by Car System and Car System Digital.

Available soon: complementary basic components such as wall elements, with gates, doors or windows at choice, steel trelliswork trusses, concrete pillars, roof elements with and without roof lights, travelling crab or various ground plate sets.

Epoch VI • 253 × 153 × 124 mm • 03/19



130179

Steel structure of apparatuses with pipes

Separate multi-storey steel structure of apparatuses with two platforms, a reactor, conduits of pipes, and typical equipment. To go with model »Chemical plant«, Art. 130175.

Epoch IV • 145 × 135 × 100 mm • 03/19

XX/19 Month of delivery

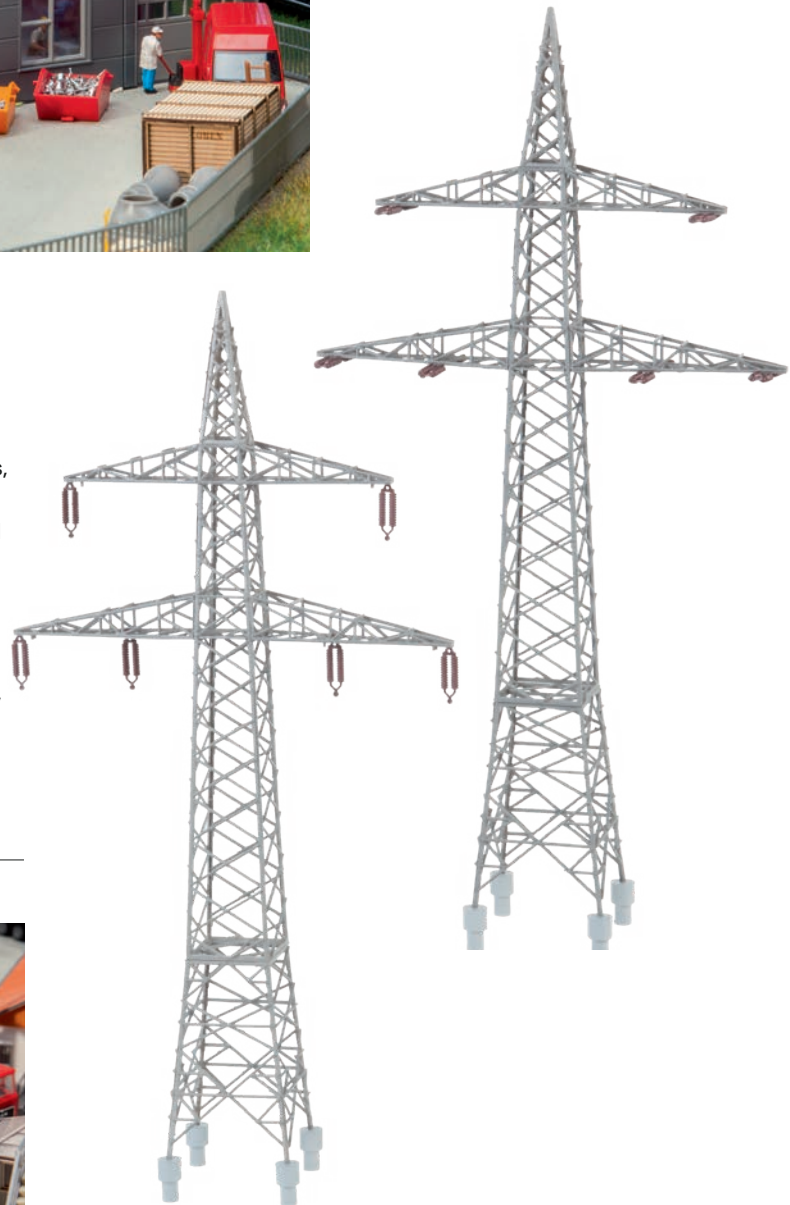

130898

2 Electricity pylons (110 kV)

Set of electricity pylons containing two identical steel German Donau pylons featuring a lower wider cross arm and an upper narrow cross arm on which insulators can be fixed upright or hanging. Can be built as one-level pylon variant, e.g. for traction power networks. Conductor cable for the transmission of electricity supplied (without function).

Epoch III • 161 × 51 × 312 mm (2 x) • 02/19



110139

»Beinwil« Station

Beinwil station is located on the line in the Seetal valley between Emmen and Lenzburg in the Aargau. That typical station fascinates through its half-timbered construction and its canopy with wooden columns. The shape novelty made of real timber and graphic arts cardboard impresses through its intense detail rendition.

Epoch II • Lasercut model • 224 × 150 × 163 mm • 03/19



Model of the month
June

191742

»Ochsenhausen« Station

With steam across Upper Swabia! Faithful reproduction of the Ochsenhausen station built in 1899 by the House of Württemberg's State Railways. The two-storey passenger building with yellow facade paint is complemented with a goods shed and a bicycle shelter annexed on one side. On the narrow-gauge line one can see the Öchsle museum railway operate today: www.oechsle-bahn.de.

Epoch II • 308 × 140 × 142 mm • 06/19



110127

»Stugl-Stuls« Station set

Pure idyll in the station area of »Stugl-Stuls« classified as a historical monument! Set of filigree laser cut models comprised of Rhaetian Railways »Stugl-Stuls« station with gatekeeper's house, which was put into operation in 1903 on the Albula line. That historical railway ensemble of wooden buildings also includes toilets and a bath house intended for passengers as well as a plain small livestock stable with asymmetric double-pitch roof. Contents: Station, gatekeeper's house, toilets, bath house, small livestock stable

Epoch I • Lasercut model • Railway station: 192 × 114 × 77 mm • Line-keeper's lodge: 116 × 92 × 75 mm • Toilet house: 47 × 50 × 37,5 mm • Bathhouse: 36,5 × 34 × 35 mm • Shed: 56 × 57 × 36 mm • 04/19

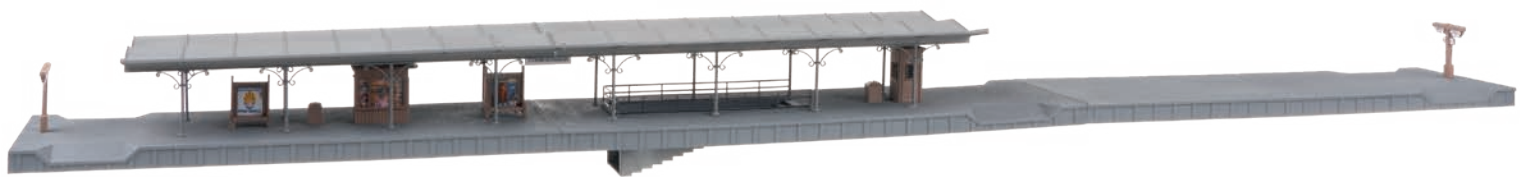

120105

»Friedrichstadt« Platform

Covered platform in filigree iron construction with passenger way out. Numerous decoration accessories such as e.g. kiosk, supervision booth, train destination indicator, benches and litter bins are part of the kit. The platform ideally matches »Friedrichstadt« station, Art. 190297.

Epoch II • 931 × 105 × 58 mm • Depth: 21 mm • 05/19

120303

Kiosk

Sales stand for snacks and beverages! Kiosk in timber and plastic construction with large windows and flat roof. The timber section consist of laser-cut parts.

Epoch III • Patinated model • Lasercut model • 85 × 80 × 47 mm • 05/19





120103

Signal tower with sandstone plinth

Narrow signal tower building with three vertical masonry semicircular gates and double-pitch roof. The control room with windows is located on the upper floor.

Epoch II • Patinated model • 204 × 74 × 143 mm • 05/19



120320

Rail brakes

Set comprised of two rail brakes and an operator's stand. The 215 mm long braking rails laid parallel to the tracks reduce the speed of waggons on the sorting descents by pressing brake clips against the wheel flanges on both sides.

Model without function.

Epoch IV • Patinated model •
Retarder: 215 × 50 × 6 mm (2 x) •
Operator's stand: 114 × 41 × 37 mm •
06/19



120310

Small train-washing system

Train and tram washing system to clean vehicles in the depot station. During the passage of a vehicle on the track, columns ensure the preliminary and final wash, while diverse stationary lateral pairs of cylinders carry out the external cleaning. The framework structure supplied allows installation outdoors. Model without function.

Epoch V • 344 × 63 × 77 mm • 04/19



120465

Viaduct set, two-track

Set comprised of a straight viaduct with track bed and high piers. Kit includes a set of bridge abutments and an additional pier to lengthen the bridge. Suitable for Märklin C track and all other track types.

Epoch II • 473 × 169 × 262 mm • 02/19



120466

Viaduct set, two-track, curved

Set comprised of a curved viaduct with track bed and high piers. A set of bridge abutments and an additional pier allowing to lengthen the bridge are part of the kit. Suitable for Märklin C track and all other track types.
For radii of curve R1 and R2.

Epoch II • 568 × 230 × 262 mm • 02/19



120501

Narrow-gauge bridges

Set comprised of a lattice girder bridge with two pedestrians' masonry subways and four other masonry abutments along with roadway parts allowing to build two other small bridges. All bridges are suitable for both narrow-gauge and normal gauge tracks. Compensating pieces are supplied.

Epoch II - Patinated model -
 Bridge 1: 309 × 48 × 87 mm -
 Bridge 2: 119 × 48 × 59 mm (2 x) -
 04/19

11



120502

Steel bridge

Box girder bridge comprised of two track beds with box structure and a bridge abutment set. Suitable for C track and all other types of track.

Epoch II - 489 × 71 × 117 mm - Clearance: 66 mm - 04/19

COLOUR
VARIANT



120503

Fish-bellied bridge

Steel bridge with two straight track beds, a fish-bellied bearer turned downwards, and masonry abutments. Suitable for all miniature tracks.

Epoch II - 472 × 87 × 82 mm - 05/19

120570

2 Tunnel portals, two-track

Two circular arc portals with natural stone masonry, cornice and crenellated parapet. The tunnel portals are suitable for both catenary operation and steam traction, and for two tracks.

Epoch I - Patinated model - 190 × 15 × 159 mm -
 Clearance width: 142 mm - Clearance: 106 mm - 02/19





130574

Breeding farm

Country life! Breeding farm comprised of a vast stable as well as an implement shed allowing to garage agricultural vehicles. Tower silos with metal framework intended for dry outdoor storage of fodder and liquid manure pit form part of the kit. The wide sliding gates on both fronts of the stable can be made to open and close by mounting the door drive unit, Art. 180624, not supplied.

Epoch IV • Stables: 265 × 146 × 93 mm • Shelter: 265 × 120 × 93 mm •
Silo: 27 × 24 × 65 mm (2 x) • Cesspit: ø 142 × 38 mm • 03/19

130168

Workshop with interior equipment

Long flat-roof building with windows all around, contains a fully fitted-up workshop with plenty of wood and metal working machines as well as comprehensive office furniture.

Epoch IV • 341 × 144 × 64 mm • 04/19





130611 Winery

Wine tasting! Patinated model of a winery comprised of two L-shaped staggered two-storey buildings with outside stairs and covered outdoor area. Corner stones, door and window jambs of the rendered building half are visible. Decoration elements such as wine-casks, wooden tubs and planters are included.

Epoch II • Patinated model • 272 × 172 × 143 mm • 05/19



180335 Wine press

Epoch II • 54 × 53 × 50 mm • 05/19



150952
Grape harvest
06/19



180972
2 Wooden casks and 2 tubs
Epoch I • 04/19

Finishing touch

Low-priced small parts such as »2 Wooden casks and 2 tubs« are of versatile use and perfectly suitable for the decoration of everyday situations on model railway installations and dioramas.

Further new sets of Small parts 2019 are to be found on page 29.

Colour
variant



130630

Historical town gate

Imposing! Sizable town gate with tower clock and four roofed corner turrets, dominates the townscape with nearly twice the height of common houses. The annexe offering a passage to pedestrians is of versatile use and can also be integrated into an urban atmosphere as individual building.

Epoch I - 112 × 78 × 390 mm - 05/19

14

130617

Corner house with post office

Multistorey dwelling house with post office on the ground floor.

Epoch II - 91 × 68 × 134 mm - 05/19



130706

Town house with shoe-shop

4-storey town building
with a shoe-shop on the ground floor.

Epoch III - 135 × 125 × 200 mm - 06/19



130705

Town house with repair shop

Multistorey town building with annexes forming a backyard and a car repair shop on the ground floor. Some windows can be made to stay open.

Epoch II - 125 × 183 × 208 mm - 06/19

130640

Renovated detached house

One-storey dwelling house with light-coloured rendered facade, white wooden balcony, and windows in the gable of the attic.

Epoch IV • 127 × 126 × 88 mm • 05/19



15

Colour variant



130641

Prefabricated house »1985«

Model of a one-storey dwelling house with garages and a terrace in the annexe.

Epoch IV • 205 × 129 × 85 mm • 05/19



180315

2 Double garages with driving parts

Set of two double garages with swinging gates that can each be driven via a servo available separately. Kit includes the required gate driving parts.

Epoch IV • 107 × 66 × 40,5 mm (2 x) • 04/19



Promotional sets

Certainly no reach-me-down items! Once-only model combinations perfectly matching a specific theme: these are our limited promotional sets. Punctually at the start of each model-making season our bespoke thematic ensembles will be launched – always with truly good value.

130613

Sports hall

Polyvalent sports hall of elegant design with spectator gallery running along the entire side wall. The filigree glass facades of the competition hall, erected over the entire height, allows a standard-girder construction.

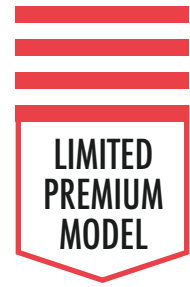

16

The facades of the lateral entrance pavilion and building aisle with locker rooms, apparatus rooms, and technical installation are rendered and printed with figures illustrating the function of the building. Roofing combines a slightly overhanging, self-supporting arched roof made of sheet steel with a flat roof fitted with solar collectors.

Epoch V • Lasercut model • 350 × 235 × 120 mm • 06/19

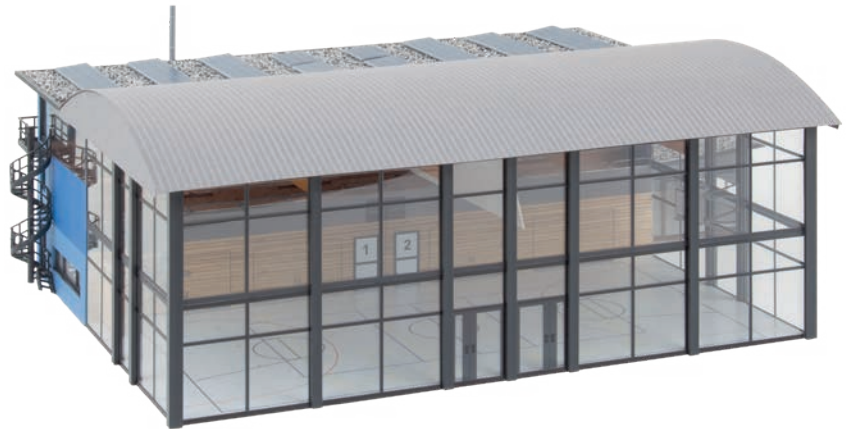

150947

Gymnasts, sportsmen
06/19





17



180354

Sports hall interior equipment

Comprehensive gymnasium equipment comprised of two handball goals and basket backboards, one large box and two little ones, several soft floor mats, trampoline, springboard, horizontal bar, buck, parallel bars and exercising bench as well as various balls. Also suitable as accessories for the 2019 PREMIUM model »Sports hall«, Art. 130613.

Epoch IV - 06/19



130604

2 Swedish houses

Very Swedish! Set comprised of a one-storey dwelling house painted in a red shade, with canopy, white gable windows and slated roof. The two-storey yellow dwelling house features an extension in the middle with a hipped roof at a right angle. The lateral entrance is roofed, the rear of the building being embellished with a typical Swedish entrance veranda.

Epoch III • House 1: 154 × 115 × 110 mm • House 2: 138 × 95 × 75 mm • 03/19



150947

Gymnasts, sportsmen

06/19



150950

At the boarding school

06/19



150951

Workers in engine depot

06/19



150952

Grape harvest

06/19



150953

Passers-by with umbrella

06/19



150954

Medical-laboratory assistants

06/19



Model of the month
January

191737
»Kyllburg« Tunnel portals

Epoch I • 190 × 36 × 193 mm • 01/19

19

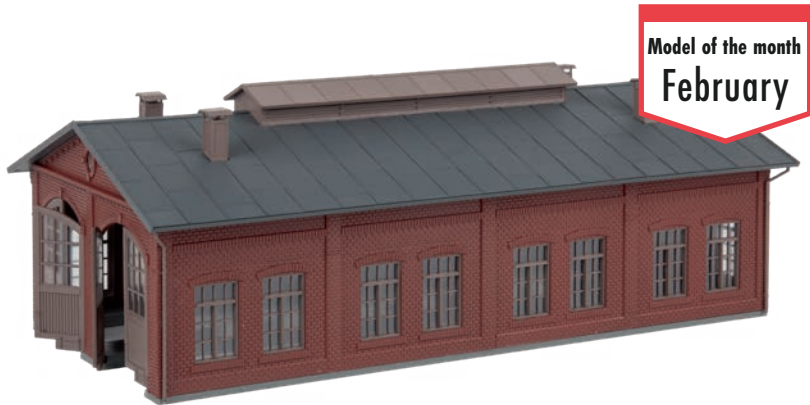

Model of the month
February

191738
Two-stall engine shed

Epoch II • 322 × 176 × 118 mm • 02/19



Model of the month
April

191740
Fodder shop

Epoch III • 124 × 190 × 270 mm • 04/19



Model of the month
March

191739
Warehouse

Epoch III • 249 × 182 × 113 mm • 03/19



Model of the month
May

191741
Entrepreneur's villa

Epoch II • 256 × 227 × 217 mm • 05/19



20

212119

»Rothenstein« Station

Long three-storey station building with covered platform, facade of symmetrical structure, semicircular arched doors and windows on the ground floor as well as a low pitched hipped roof. Can also be built without roofing.

Epoch I • 135 × 112 × 120 mm • 05/19



232382

Historical town gate

Historical town gate with lateral extension, which can also be used separately, in a row of town houses for instance. Salient stairway allowing to reach the actual ascent within the tower by means of winding stairs. The top of the tower features four roofed corner turrets.

Epoch I • 81 × 57 × 270 mm • 03/19





222222

THW building with vehicle hall

One-storey building set comprised of an office pavilion with square base, three-stall garage wing with movable sliding gates (without drive) as well as three roofed parking spaces for vehicles and tools. Office and garage are connected with each other through a passage.

Epoch V • Building: 202 × 113 × 50 mm • Vehicle hall: 110 × 60 × 48 mm • 04/19

21



232198

Farm with three aisles

Rural farm comprised of a dwelling house of half-timbered construction, a barn, one stable each for sheep and swine, with adjoining lattice fencing. The elements can also be built separately from each other. Accessories such as dog-kennel, stork's nest and many others more are included.

Epoch I • 195 × 168 × 66 mm • 06/19



22

232398

»Erlenhof« Stud farm

Two-storey building ensemble on an L-shaped base, serving as a stud farm for horse-breeding. The wall side with stalls looking to the courtyard is digitally printed.

Epoch II • 179 × 125 × 91 mm • 07/19



222572

Railway/road bridge

Arched bridge with one opening, styled with rocks and ornamental elements, can be lengthened at will. Multiple uses as railway or road bridge.

Epoch I • Patinated model • 192 × 74 × 70 mm • Arc height: 51 mm • 02/19



23



222573

Modern arched bridge

The fascination of bridges! Modern, wide-span concrete arched bridge with two adjoining bays on both sides and abutments, similar to the Rehtal bridge in Thuringia. Can be used with two tracks and suitable for all miniature tracks.

Epoch VI • Patinated model • Arched bridge: 662 × 89 × 138 mm •
Arc height: 102 mm • 10/19



CAR SYSTEM DIGITAL PURE INNOVATION

Road show! Cars are an element of our culture and as such simply exciting. Integrated in your installation as miniature road traffic in motion, they provide an extraordinary overall impression embracing your building models and your landscape arrangement. With »Car System Digital« you are going to exhaust all the benefits offered by modern information and communication technology to scale modelling, and will be able to focus on what really counts here: **your creativity.**

Learn more on our site www.car-system-digital.de



Also control-
lable by App
in 2019

CAR SYSTEM – THE CLASSIC INSTALLATION



161642
Truck MB Atego, white
 (HERPA) • **Epoch V** • 10/19



161485
MB 0302 »Touring«
 (WIKING) • **Epoch III** • 05/19



161472
Car System Conversion chassis »VW T5«
 Pre-assembled, fully functioning Car System H0 chassis to convert two-axle stationary VW T5 models of manufacturer WIKING for Car System operation.
 06/19

25



163780
Assorted stranded wires
 0.04 mm², 10 colours, 10 m each
 06/19

Stranded wire 0.04 mm², 10 m			
06/19			
163781	red	163786	blue
163782	black	163787	violet
163783	green	163788	brown
163784	grey	163789	orange
163785	yellow	163790	white



190847 190847GB (H0, N)
Pro Tips »Car System«
 Planning, Design, Technique – The indispensable reference and learning book for fascinating miniature road traffic. The comprehensive manual »Pro Tips Car System« contains all fundamentals as well as detailed expert know-how relating to the topics Vehicles, Road building and Traffic control. Learn step by step the essential working techniques leading to the successful operation of Car System, and immediately implement your own ideas and projects.



181524 (H0, TT)

15 Deciduous trees, assorted

75 - 100 mm - 03/19



181529 (H0, TT)

15 Mixed forest trees, assorted

70 - 90 mm - 03/19

181530 (H0, TT)

30 Mixed forest trees,
assorted

50 - 120 mm - 03/19



181542 (H0, TT)

15 Firs, large

90 - 150 mm - 03/19



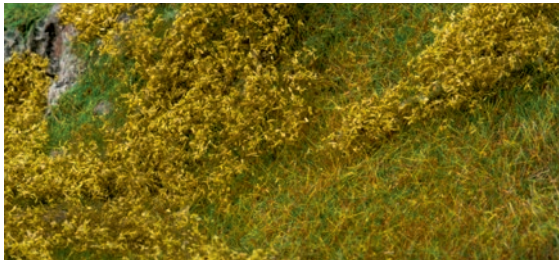

181615
Clump foliage, light green

ca. 300 × 200 mm • 01/19



181616
Clump foliage, dark green

ca. 300 × 200 mm • 01/19



181617
Clump foliage, various colours

ca. 300 × 200 mm • 01/19



181618
Clump foliage, summer green

ca. 300 × 200 mm • 01/19



170715
Reeds
ca. 80 mm • 01/19



170769
High grass, Set of 4
ca. 80 mm • 05/19



171395
Grass tufts, pale
Height: 6 – 12 mm • 05/19



171396
Grass tufts, dark
Height: 6 – 12 mm • 05/19

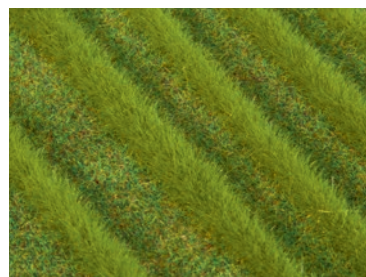

171397
Grass strips, pale
Height: 6 – 12 mm • 05/19



171398
Grass strips, dark
Height: 6 – 12 mm • 05/19

**TOP
SELLER**

Improved! A better colour temperature and luminous efficiency as well as a larger angle of radiation ensure a particularly homogeneous illumination of building models. **In FALLER kits the optimized cap accurately adapts to the provided holders.**
12-16 V, AC/DC.



180667
Lighting fixture LED, warm white



180668
Lighting fixture LED, cold white



180692
Drive unit for elevator

Drive unit suitable for models »Clinic«, Art. 130809 and »Modern lift with drive parts«, Art. 120297. Allows the lift to drive up and down, and stop in any position.
Contents: 1 x Printed card with rectifier, 1 x Motor with endless screw, 1 x Switch, 2 x Limit switch, Stranded wires
03/19

170540
Modeller's knife with 20 blades, soft grip

Aluminium! Makes any cutting and sawing work easier in the hobby and scale modelling sector for paper, cardboard, plastic, wood and sheeting. The soft grip is superhandy, even in the long run, while ensuring additional safety when seizing it. The reinforced grip also allows minor sawing work. A magnet at the tip of the knife makes it easy to pick up blades or tiny metal pieces. The turning fastener allows to replace the different blades easily and rapidly. Includes 4 types of scalpel and saw blades. Including a box for safe storage.



170688
Special side cutter

For cutting off ultra-fine moulded parts without burrs. Only suitable for polystyrene and copper wires.





180966
Large gas tank
 Epoch IV • 02/19



180967
Concrete mixer
 Epoch IV • 02/19



180968
4 Beer case with bottles
 Epoch IV • 02/19



180969
2 Level crossings
 Epoch III • 02/19



180970
9 Plastic barrels
 Epoch IV • 02/19



180971
10 Aluminium beer barrels
 Epoch V • 02/19



180972
2 Wooden casks and 2 tubs
 Epoch I • 04/19



180973
7 Garden pools
 Epoch V • 04/19



180974
Butcher's shop interior decoration
 Epoch III • 02/19



180975
Wheelbarrow
 Epoch IV • 02/19



180976
13 Air conditioners
 Epoch V • 06/19



272914
Building site silo
 Epoch V • 13 × 14 × 35 mm • 04/19



272915
Fodder silo
 Epoch V • 27 × 15 × 50 mm • 04/19



272916
Solar cells
 Epoch V • 36,5 × 8 × 1 mm (6 x),
 12 × 8 × 1 mm (4 x), 21,5 × 14 × 1 mm (1 x) •
 04/19

MADE IN BLACK FOREST

Fascination model making



130591

»Brandshof« Filling station

Epoch III • Patinated model • 285 × 210 × 53 mm



130594

»Old gate house« Restaurant

Epoch II • Lasercut model • 91 × 63 × 68 mm



222217

Fodder shop

Epoch III • Silo: 83 × 83 × 110 mm • Warehouse: 100 × 80 × 220 mm



282795

»Kandelhof« Cinema

Epoch III • Lasercut model • 152 × 58 × 96 mm



OUTLOOK

... and many other surprises in the course of 2019.



1

Simply
let you inspire

2

Easy order
online



The new FALLER online shop cannot replace the commitment and know-how of our commercial partners present on site. A large number of retailers and partners are readily available to our customers as experienced interlocutors.

You will find a specialised retailer shop in your neighbourhood under »Retailer search« at www.faller.de

Available soon

FALLER.DE ONLINE SHOP



Direct to the huge selection



Large range of products

Nearly everything for scale modelling and the decoration of model railway installations: kits, animated models, Car System, tools, and plenty of useful products for model installations.



Swift dispatch

We dispatch within the entire delivery area without delays, and as quickly as possible as far as articles are in stock.



Service included

With plenty of useful tips and tricks, step-by-step instructions for use to download, and online catalogues to browse through.



Return free of charge

Buy entirely without any risk: Un-opened products may be returned within 14 days. Free of charge.



3

Receive the
desired product
perfectly relaxed



FALLER brands



TOMYTEC





WALTHERS

You can get extensive catalogues and detailed brochures at a model construction store near you and via:
www.faller.de

Your FALLER Retailer

Gebr. FALLER GmbH
Kreuzstraße 9
78148 Gütenbach
Germany

Phone +49 7723 651-0
info@faller.de

 www.faller.de
 www.car-system-digital.de
 www.facebook.com/faller.de

